

SOFT LANDSCAPE/PLANTING KEY

PLANTING SYMBOL	APPEARANCE	TYPE
		SAXIFRAGACEAE-ASTILBE CHINENSIS HARDY PERENNIAL-HT./SPREAD 0.5-1M (2-5YEARS) LOAM-PH. ACID, ALKALINE, NEUTRAL
		ADOXACEAE-VILBURNUM TINUS 'EVE PRICE' HARDY EVERGREEN-HT./SPREAD 1.5-2.5M (10-20YEARS), LOAM, CLAY, SAND, CHALK-PH. ACID, ALKALINE, NEUTRAL FULL/PARTIAL SUNSHADE
		MAGNOLIACEAE-MAGNOLIA 'MERRILL' HARDY PERENNIAL-HT./SPREAD 4-8M (20-50YEARS), LOAM, CLAY, SAND, PH. ACID, NEUTRAL, PRUNING- MID SUMMER FULL SUN/ PARTIAL SHADE/ SHELTERED

NOTE: INSTALLATION OF PLANTING BY SPECIALIST LANDSCAPE CONTRACTOR, DURING DORMANT PERIOD.

MAINTENANCE REGIME TO BE DETERMINED BY LANDLORD. REGULAR PRUNING TO BE UNDERTAKEN TO ENSURE LARGER PLANTS ARE CONTAINED.

HARD LANDSCAPE/ MATERIAL KEY

HATCHING	TYPE
	TARMAC COLOUR 1 - TO BE CONFIRMED
	TARMAC COLOUR 2 - TO BE CONFIRMED. DOTTED LINES DEMARK WHITE LINING

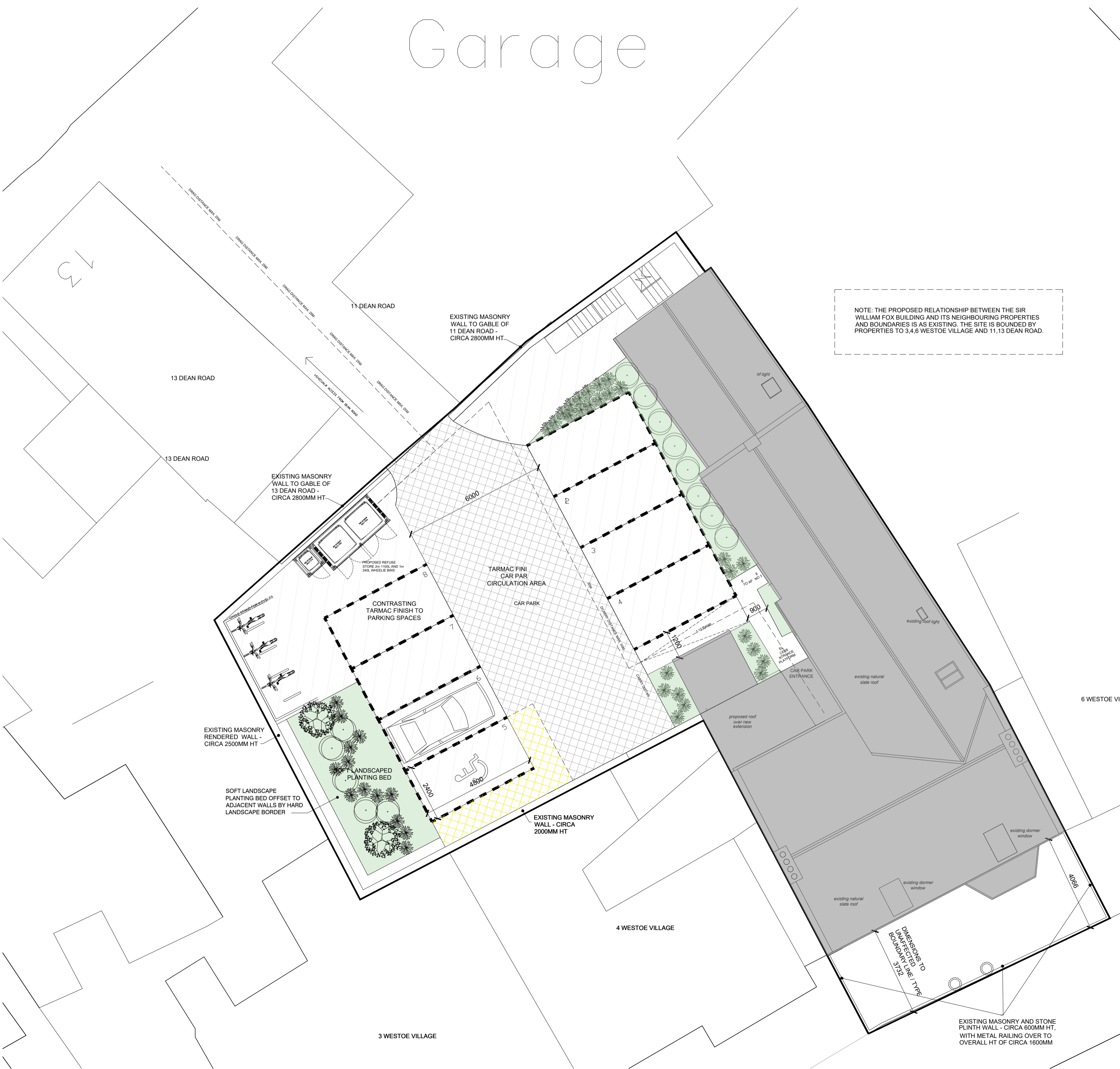

NOTE: THE PROPOSED RELATIONSHIP BETWEEN THE SIR WILLIAM FOX BUILDING AND ITS NEIGHBOURING PROPERTIES AND BOUNDARIES IS AS EXISTING. THE SITE IS BOUNDED BY PROPERTIES TO 3.4.6 WESTOE VILLAGE AND 11.13 DEAN ROAD.

Revised By	GS	Date	15/10/20	Checked By	DB
S4 P01.07 SOFT LANDSCAPE PLANTING BED TO WESTERN BOUNDARY STEPPED OFF ADJACENT WALL LINES WITH HARD LANDSCAPE BORDER					
Revised By	GS	Date	25/09/20	Checked By	DB
S4 P01.06 GROUND FLOOR EXTENSION (ENSLUTE) TO APARTMENT 3 OMITTED					
Revised By	GS	Date	14/07/20	Checked By	DB
S4 P01.05 SITE LAYOUT UPDATED TO SUIT PLANNING & CLIENT COMMENTS					
Revised By	GS	Date	28/03/20	Checked By	DB
S4 P01.04 AMENDED TO SUIT REVISED SURFACE TREATMENT					
Revised By	GS	Date	25/02/20	Checked By	DB
S4 P01.03 AMENDED TO SUIT REDUCTION OF DWELLING RESULTING IN LOSS OF 2NR PARKING BAYS					
Revised By	GS	Date	12/02/20	Checked By	DB
S4 P01.02 AMENDED TO SUIT REVISED LAYOUT					
Revised By	GS	Date	01/11/19	Checked By	DB
S4 P01.01 SITE LAYOUT AMENDED TO SUIT PRE-APPLICATION COMMENTS					
Revised By	GS	Date	19/08/19	Checked By	DB
[S4] [P01] 1. FIRST ISSUE					



BLAKE HOPKINSON ARCHITECTURE
ARCHITECTURE + DESIGN

BLAKE HOPKINSON ARCHITECTURE LLP 16327463
NORTH SHIELDS, TYNE & WEAR - 0191 2570022 - www.bharchitecture.co.uk

BHA Project No:
RES736

Project Name:
**SIR WILLIAM FOX HOTEL
5 WESTOE VILLAGE
SOUTH SHIELDS**

Drawing Title:
PROPOSED LANDSCAPE PLAN

Model File Name: RES736-BHA-00-ZZ-M2-A-1500

Drawn By: **GS** Date Drawn: **16/08/19**

Checked By: **DB** Date Checked: **19/08/19**

Scale at A1: **1:100** Suitability: **S4** Revision: **P01.07**

File Name:
RES736-BHA-00-ZZ-DR-A-2002